

MAHLKÖNIG *home*



X54 Allround Home Grinder

ESPRESSO  
EROPRESS  
60 FILTERCH  
EMEXFRENCO  
HPRESS

MAHLKÖNIG *home*





# THE KING OF GRINDERS

—

Passionate coffee enthusiasts strive to create a truly unique taste experience with every single cup. Just as the bean variety, the roast profile and brewing method, all have major influences on the final result, so does the grinder. The right dose, grinding speed, particle size and shape, all combine to make or break the perfect extraction. If you want to unlock the full aroma of your precious coffee, compromising on your grinder's performance is not an option.

Mahlkönig coffee grinders stand for quality leadership, a spirit of innovation and a genuine passion for coffee. Using great care, only the highest quality materials get selected and assembled by experienced technicians to create high-end tools for coffee preparation. With unmatched performance and excellent grinding results, Mahlkönig has earned the deep trust of professional baristas around the globe. Our grinders are known to be the very best available to achieve the highest possible quality - providing a unique coffee taste experience.





# MAHLKÖNIG *home*

*Experience premium grinding - at home*

---

Mahlkönig's next generation espresso grinder features a perfect synergy of premium espresso grinding technology and pioneering features, designed to meet the highest demands of coffee professionals.

We fully recognize that home baristas long to experience premium coffee grinding, so we set out to establish the same high-quality standard for personal coffee bars with a new dedicated product category: "Mahlkönig home". The result is a home grinder that features the same iconic look, excellent grinding and perfect functionality – specifically sized for domestic use.



# X54 Allround Home Grinder

## key features



### **allround** home grinder

*35 steps from espresso all the way  
up to French press*



### **reduced** noise

*Ultra quiet grinding  
at < 70 dB(A)*



### **54 mm** special steel burrs

*Even particles for an incredible  
taste experience*



### **high** durability

*Motor lifetime  
> 25.000 shots*



### **premium** multifunctional led display

*4 timer presets and manual mode*



### **2 easily** swappable fronts

*Portafilter support and grounds  
container included*



# be your own barista

## *X54 allround home grinder*

---

The everyday coffee enjoyment really matters. Freshly roasted specialty varieties prepared by a skilled barista with professional premium equipment can turn a small coffee break into a meaningful moment of joy. We have developed the X54 allround home grinder so that you can experience these coffee moments of joy at home, too. The grinder enables optimal grinding that meets even the highest demands. As a true allrounder, the grinder is suitable for many preparation methods: for your aromatic espresso in the morning just as for your pour-over or French press in the afternoon.

The Mahlkönig X54 allround home grinder is the best choice for every home barista.





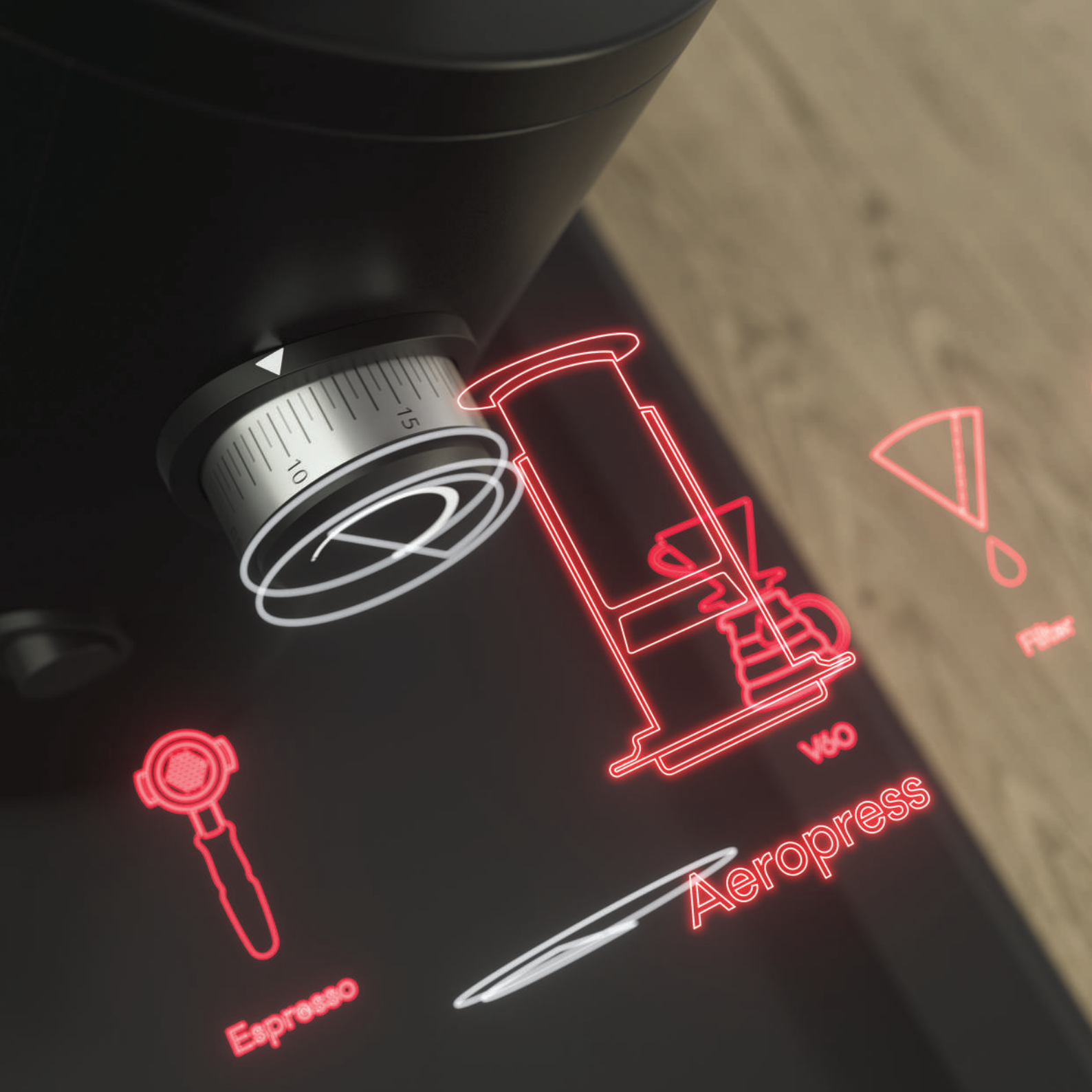

# one for all

***35 steps from espresso all the way  
up to French press***

Up to now home baristas have had a difficult choice to make - either buying a filter grinder or an espresso grinder - or maybe even investing in two machines that would take up significant space in the kitchen.

The X54 features premium grinding for any brewing method. Its grind size adjustment ranges through 35 steps, from espresso all the way up to French press. What lies beneath this comprehensive scale is a uniquely conceived set of burrs that can produce particles of less than 200 at the finest and up to 1,000  $\mu\text{m}$  at the coarsest setting.

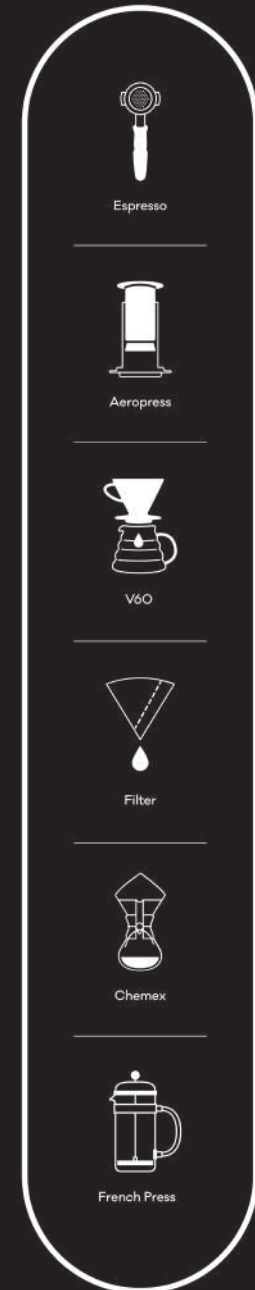



# 54 mm special steel burrs

*Even particles for an incredible  
taste experience*

---

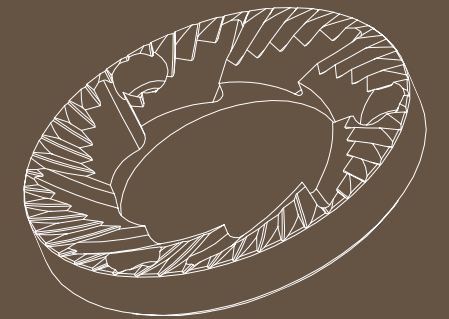

When it comes to manufacturing the flagship of grinding technology, we leave nothing to chance. Hence, we keep the engineering and production departments for our burrs exclusively in-house. Whilst continuously analyzing recent and upcoming market requirements, our engineers use their expertise and skills to shape the innovative spirit of Mahlkönig. Using the latest computer-controlled technology, each burr acquires its individual shape and finishing touch under the watchful eyes of our experienced production team in Hamburg.

For almost 100 years, Mahlkönig has been compiling a comprehensive catalogue of different tooth profiles and grinding surface patterns, allowing us to select the perfect set of all-round burrs for the X54. Manufactured from high quality special steel, each set of burrs will grind approx. 800 kg of beans, depending on the roast. The sophisticated design of the 54 mm burrs guarantees gentle grinding and optimal particle sizes across a broad range - from espresso to French press. As a result, the X54 allows all your precious coffees to become unforgettable taste experiences, served at your home coffee bar.



# 2 easily swappable fronts

*Portafilter support and grounds container included*



Are you missing out on a perfectly fitting bin to securely collect your grounds? Would you like to rest your portafilter on a sturdy support during the grinding process? The X54 comes with both, a stainless steel Mahlkönig cup and a rock-steady portafilter support that fits any common portafilter size.

Whenever you need to swap from filter to espresso grinding, or vice versa, all you have to do is to press one button and quickly exchange the front on your X54 and all your precious grounds will get collected smoothly.







# premium multifunctional led display

## *4 timer presets and manual mode*

---

The multifunctional push and turn button lets you navigate through the intuitive menu on the LED-display and set the timer within seconds. Offering up to 4 easily programmable recipes, the X54 lets you preset times, for example: one cup, one filter batch, one single or one double-shot, to cover your most common brews. If you would rather grind freestyle, the manual grinding mode lets you do just that. When it's time to grind, you simply choose the dose you need, insert the portafilter or bin - and let the X54 create the perfect grounds.

# 25.000 shots

**High durability: motor lifetime > 25.000 shots**

---

Mahlkönig grinders are known for their longevity and the X54 fully lives up to this reputation. The concept of this grinder is to provide convenient ease of use at your home coffee bar, for many years. The durable compact motor inside the X54 provides a lifetime of more than 25,000 shots. As a matter of fact, the X54 is a robust piece of equipment that you are not going to replace anytime soon.



## < 70 dB(A)

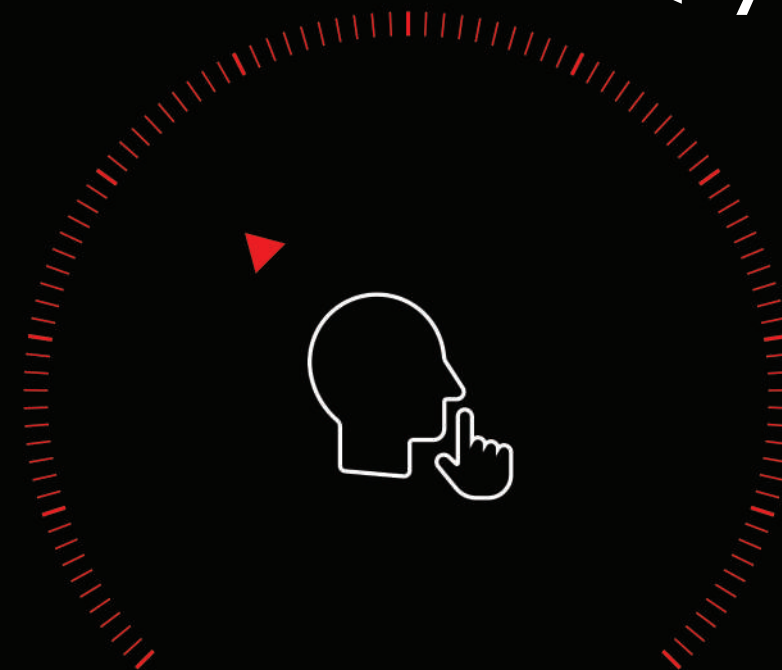

# reduced noise

**Ultra quiet grinding at < 70 dB(A)**

---

We all want to enjoy our coffee without disturbance. With this in mind, a team of Mahlkönig engineers and acoustics experts developed the body of the X54 with a strong focus on noise reduction and frequency optimization. The sturdy grinder housing and foam-insulated side covers deepen the grinding sound to below 70 dB(A).



# down to the last detail

## ***Absolutely indestructible: the bean hopper***

The ultra-robust bean hopper of the X54 is practically unbreakable. So, if you consider using multiple hoppers for different varieties, you do not have to worry about your hoppers wearing out, even if you exchange them several times a day. Furthermore, the integrated slide lets you close the hopper securely before removing it. Just fill your hopper with up to approx. 500 g of beans and start preparing your wonderful coffee creations.



## ***Keep it clean: the drip tray***



The drip tray with its optimal size, shape and position helps to keep your kitchen clean and free from coffee powder. Held in place by two strong magnets, it self-adjusts and easily slips into position, making it simple to detach, wipe and put back into place.





# TECHNICAL DETAILS

Voltage // frequencies // phases // nominal power	220-240 V // 50/60 Hz // 1~ // 120 W 110-127 V // 60 Hz // 1~ // 120 W 100 V // 50/60 Hz // 1~ // 120 W
Idle speed	1050 rpm
Burr diameter	54 mm
Burr material	Special steel
Average grinding capacity*	approx. 1-2.8 g/s
Bean hopper capacity	approx. 500 g
Dimensions (w x h x d)	19 x 42.5 x 28 cm
Dimensions of packing (w x h x d)	50 x 34 x 26 cm
Net weight	5.1 kg
Gross weight	8 kg
Certifications	CB, CCC, CE, ETL, KC, NSF, PSE, RCM
Standard colors	Matte black
Special equipment (included)	Stainless steel Mahlkönig cup 2 swappable fronts

\*Depends on the grinding goods and the chosen degree of fineness. | All measured values under laboratory conditions.  
Other electric specifications available on request. | Subject to change without prior notice.









[www.mahlkoenig.de](http://www.mahlkoenig.de) | [www.hemrogroup.com](http://www.hemrogroup.com)