

Tutti i modelli / All models: F80C - F120 - F125C - F200 - SF300 - SF500 - SFN1000 - SFN2200

Dati Tecnici - Specifications

	cond	comp. W	ABS. W	Fuse	Kwh/100Kg	l/h	kg	Lbs	kg	Lbs	Ton CO2 equiv.
F80C A		702	400	10	12.5	3.2	53	117	60	132	0,43
F80C W		702	350	10	9.8	20	52	115	59	130	0,43



Produzione Ghiaccio - Ice Production

Raffreddamento ad aria - Air Cooled Unit

Temp. aria Air Temp.	Temp. acqua / Water Temp.			
	32°	21°	15°	10°
°C	32°	21°	15°	10°
°F	90°	70°	60°	50°
10°	78	84	87	90
50°	172	185	192	198
21°	72	78	81	84
70°	159	172	179	185
32°	58	63	66	68
90°	128	139	145	150
38°	48	52	54	56
100°	106	115	119	123

Raffreddamento ad acqua - Water Cooled Unit

Temp. aria Air Temp.	Temp. acqua / Water Temp.			
	32°	21°	15°	10°
°C	32°	21°	15°	10°
°F	90°	70°	60°	50°
10°	76	81	84	86
50°	168	178	185	190
21°	72	77	80	82
70°	159	170	176	181
32°	68	74	76	78
90°	150	163	168	172
38°	64	70	71	72
100°	141	154	156	159

Vista frontale
Front view

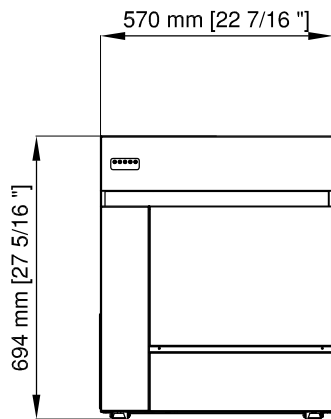

Vista laterale
Lateral view

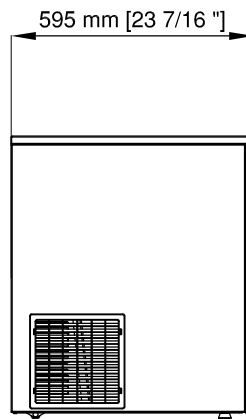

Vista posteriore
Rear view

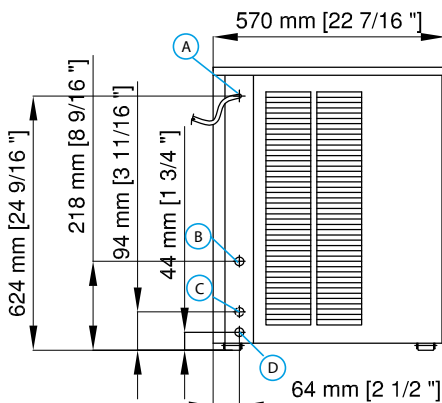

- A** Alimentazione elettrica
Electrical cable supply
- B** Attacco entrata acqua 3/4" gas
Water inlet connection 3/4" gas
- C** Uscita acqua condensazione ad acqua Ø 20 mm
Water outlet connection-Water condensation Ø 20 mm
- D** Attacco scarico acqua
Water drain Ø 20 mm



PANNELLO DI CONTROLLO - CONTROL PANEL



CAPACITA' DEPOSITO - BIN CAPACITY

20 Kg - 44 lbs

DIMENSIONI - DIMENSIONS

LxPxH(mm): 570 x 600 x 695
WxDxH(in): 22" 7/16 x 24" 10/16 x 27" 6/16

DATI SPEDIZIONE / SHIPPING DATA

LxPxH(mm): 640 x 660 x 870
WxDxH(in): 25" 3/16 x 26" x 34" 4/16

TIPO GHIACCIO - ICE TYPE

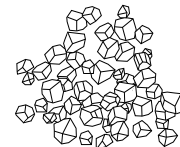

PERCENTUALE ACQUA RESIDUA 25%
ICE CONTAINS 25% RESIDUAL WATER

CONDIZIONI USO-OPERATING REQUIREMENTS

Calore espulso / Rejected Heat 1014 W

Volume aria / Air Volume 185 m³/h



220-240/1/50Hz R134a GWP=1430

MIN		MAX
30 µS/cm		500 µS/cm
10°C (50°F)		40°C (104°F)
10°C (50°F)		35°C (95°F)
- 10 %		+ 10 %
1 Bar (14 psi)		5 Bar (70 psi)

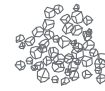

Dati Tecnici - Specifications

	cond	comp. W	ABS. W	Fuse	Kwh/100Kg	I / h	kg	Lbs	kg	Lbs	Ton CO2 equiv.
SFN2200 RC			250	1			223	491	241	530	- - -

Icematic



Produzione Ghiaccio - Ice Production LHMCT

Temp. aria Air Temp.	Temp. acqua / Water Temp.			
	32°	21°	15°	10°
°C	32°	21°	15°	10°
°F	90°	70°	60°	50°
10°	1	2		2500
50°				5512
21°				
70°				
32°				
90°				
38°				
100°				

Vista frontale
Front view

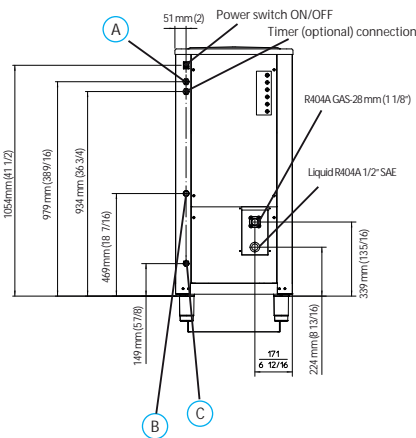

Vista laterale
Lateral view

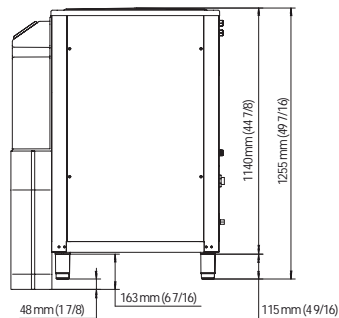

Vista posteriore
Rear view

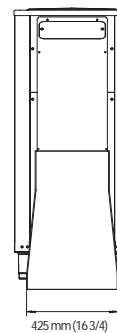

Vista superiore
Top view

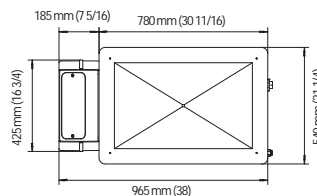

- A** Alimentazione elettrica
Electrical cable supply
- B** Entrata acqua 3/4" gas
Water inlet 3/4" gas
- C** Scarico acqua
Water drain ø 20 mm

Completo di valvola termostatica R404a, solenoide linea liquido, scambiatore di calore, valvola regolatrice di pressione, bocchetta, coperchio e tubo scarico ghiaccio in ABS, quadro elettrico di comando con protezioni.

Fitted with R404A expansion valve, solenoid valve on liquid line, heat exchanger, pressure regulating valve, cover and ice chute in ABS, electrical control panel with protections.

DEPOSITO - SLOPE BIN

UD1000 - DR620

DIMENSIONI - DIMENSIONS

LxPxH(mm): 540 x 780 x 1140 - 1255

DATI SPEDIZIONE / SHIPPING DATA

LxPxH(mm): Y

TIPO GHIACCIO - ICE TYPE

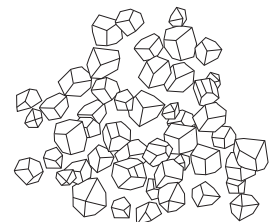

PERCENTUALE ACQUA RESIDUA 15-18%
ICE CONTAINS 15-18% RESIDUAL WATER

CONDIZIONI USO - OPERATING REQUIREMENTS



400V / 50Hz



R* GWP=

MIN

MAX

10°C (50°F)



40°C (104°F)

5°C (41°F)



35°C (95°F)

- 10 %



+ 10 %

1 BAR (14 PSI)



5 BAR (70 PSI)